

## ACCESS

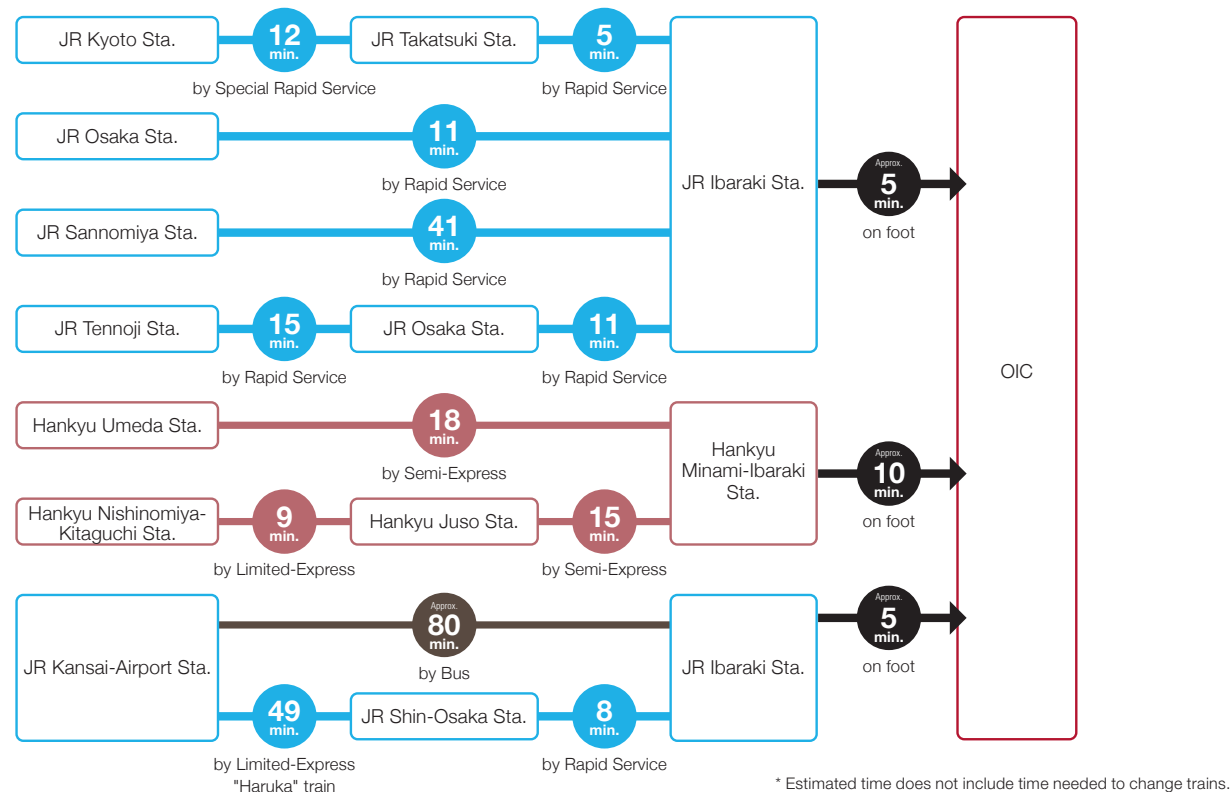

The campus is located in a convenient area with easy access to JR, Hankyu and Osaka Monorail lines, which will allow more students to commute from further areas, as well as the Shinkansen line and airports, which will promote a wider network with other cities within and outside of Japan.

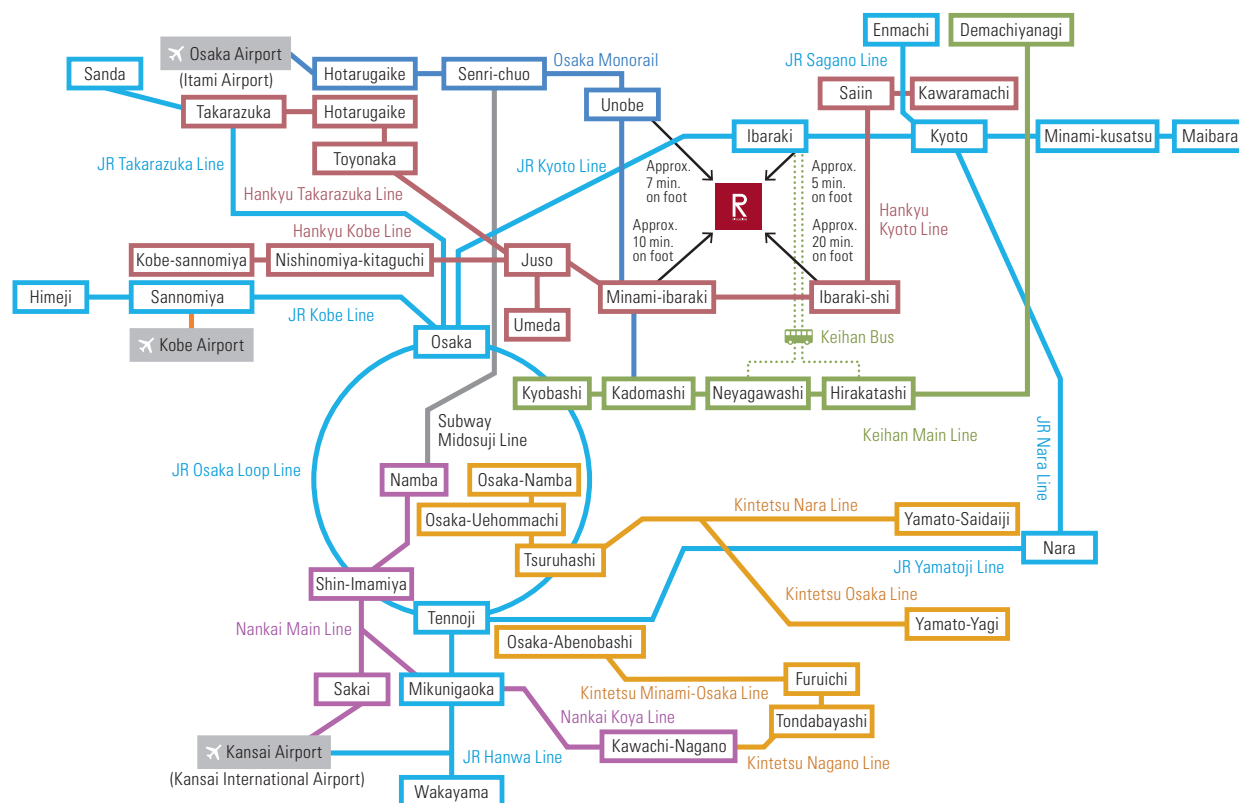

To All Undergraduate and Graduate Students Moving to  
**Osaka Ibaraki Campus**

**OIC**

RITSUMEIKAN  
UNIVERSITY  
O S A K A  
I B A R A K I  
C A M P U S

**The new Osaka Ibaraki Campus will be opening in April 2015.**

This booklet provides an overview of the new campus as well as information related to studies, student activities and student life at the new campus and surrounding areas. We hope you will use this booklet to imagine your new life at the Osaka Ibaraki Campus, talk to your friends and family about it, and start preparing for the move.



What kind of campus will it be?



Please see the website below for the latest plans and news for Osaka Ibaraki Campus.

<http://www.ritsumei.ac.jp/rs/r2020/campus/oic/>

Publisher: Ritsumeikan University Office for the Preparation of Osaka Ibaraki Campus, Ritsumeikan University Office of Student Affairs (Kinugasa)  
e-mail: [ibaraki@st.ritsumei.ac.jp](mailto:ibaraki@st.ritsumei.ac.jp)

Jun, 2014

# 1 About Ibaraki City

Rose Garden in Wakasono Park



Woodlands in the Sendaiji area of northern Ibaraki City

The campus is being built in an urban area situated in the southern half of the city. The northern half is filled with scenic nature such as the Oinosaka mountain range within the Tanba Plateau. There are also many parks and areas of greenery within the city.

## Greenery

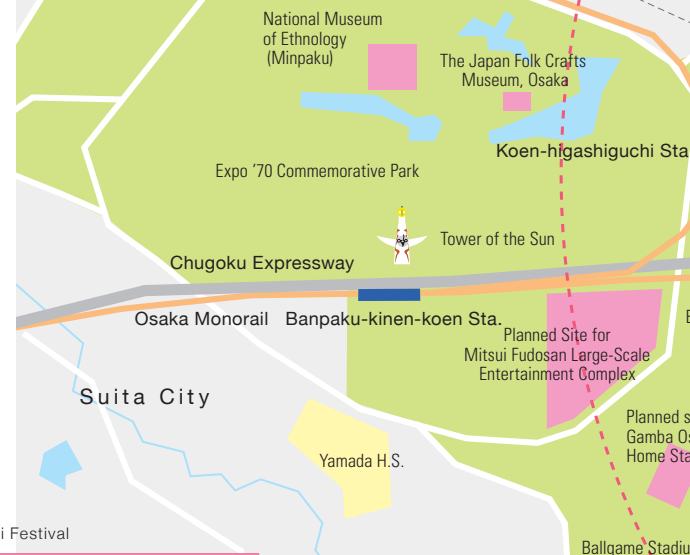

Ibaraki Festival



Various festivals and events are hosted in this lively city throughout the year.

### Main events

- Mar Shimin Sakura Festival (Moto Ibaraki-gawa Green Belt)
- May Ibaraki Music Festival
- Jul Ibaraki Festival
- Aug Ibaraki Bente Fireworks
- Ibaraki-doji Festival
- Sep Ibaraki Bakuon Fest
- Nov Farmer's Festival
- Dec Illumination



Ibaraki Music Festival

## Active

2.4km radius from the Osaka Ibaraki Campus  
Approx. 10 min by bicycle



## Accessible

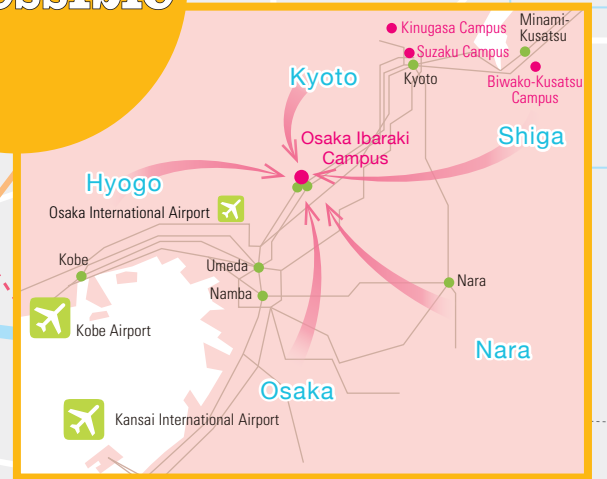

The campus is located between Osaka City and Kyoto City with easy access to the Shinkansen line and airports making domestic and international travel easier.

## Convenient

The city is well supplied with commercial districts, supermarkets and large shopping centers near the stations and across the city.



Campus construction site



- Supermarket
- Library
- Hospital

(Taken Feb 21, 2014)



# 2 About Osaka Ibaraki Campus

## The Goal of the New Campus

Ritsumeikan established the R2020 Mid-Term Plan for year 2020, with a basic plan including the goal of “creating campus environments that support education, research and student life.” Preparations are underway for improving existing campuses (Kinugasa, BKC) and opening the Osaka Ibaraki Campus. The Osaka Ibaraki Campus will open in April 2015 and house the College and Graduate School of Business Administration, College and Graduate School of Policy Science, Graduate School of Technology Management, and Graduate School of Management. In addition, the new College of Comprehensive Psychology is scheduled to launch in April 2016. The campus is

expected to facilitate collaboration with industry and government institutions, promote the Ritsumeikan Academy’s activities on the frontline of social

collaboration and exchange, and support the further development of undergraduate and graduate students.



View From Iwakura Park  
\* Perspective image according to concept as of March 2014.

## Three Core Concepts of the New Campus

Campus creation and academic development is guided by three core academic concepts. The concepts take advantage of the qualities of an urban situated campus and of the colleges and graduate schools that compose the campus.

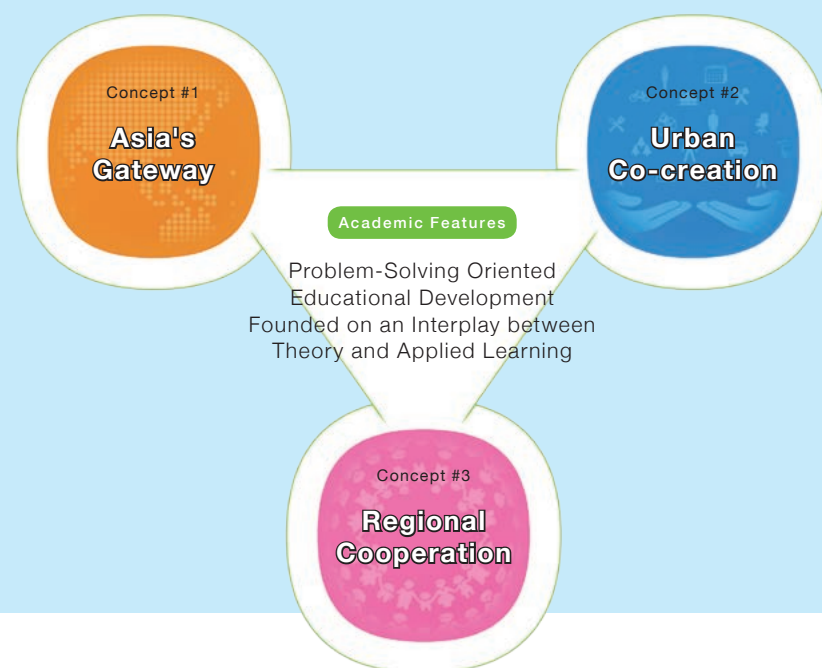

### Concept #1 Asia's Gateway

We will act as a gateway that interconnects people and knowledge— linking Asia to the world and the world to Asia— by utilizing the wealth of accumulated experience and knowledge that an advanced nation such as Japan has to offer.

### Concept #2 Urban Co-creation

We will connect a diverse group of people and organizations in the urban area. This will capitalize upon the potential interspersed throughout the city. Through creative connections we will aim to generate new values.

### Concept #3 Regional Cooperation

We will contribute to creating a rich community and society by expanding the fields of education, research and student activities through community and social collaboration, and building relationships of mutual trust through diverse activities.

## Campus Plan

The campus will have no outer wall, symbolizing its openness to the community and society that offers a plethora of diverse knowledge. Another goal is to ensure lots of greenery—there will be a garden jointly managed by citizens and students, and a woodland "satoyama" area.



Sky Plaza

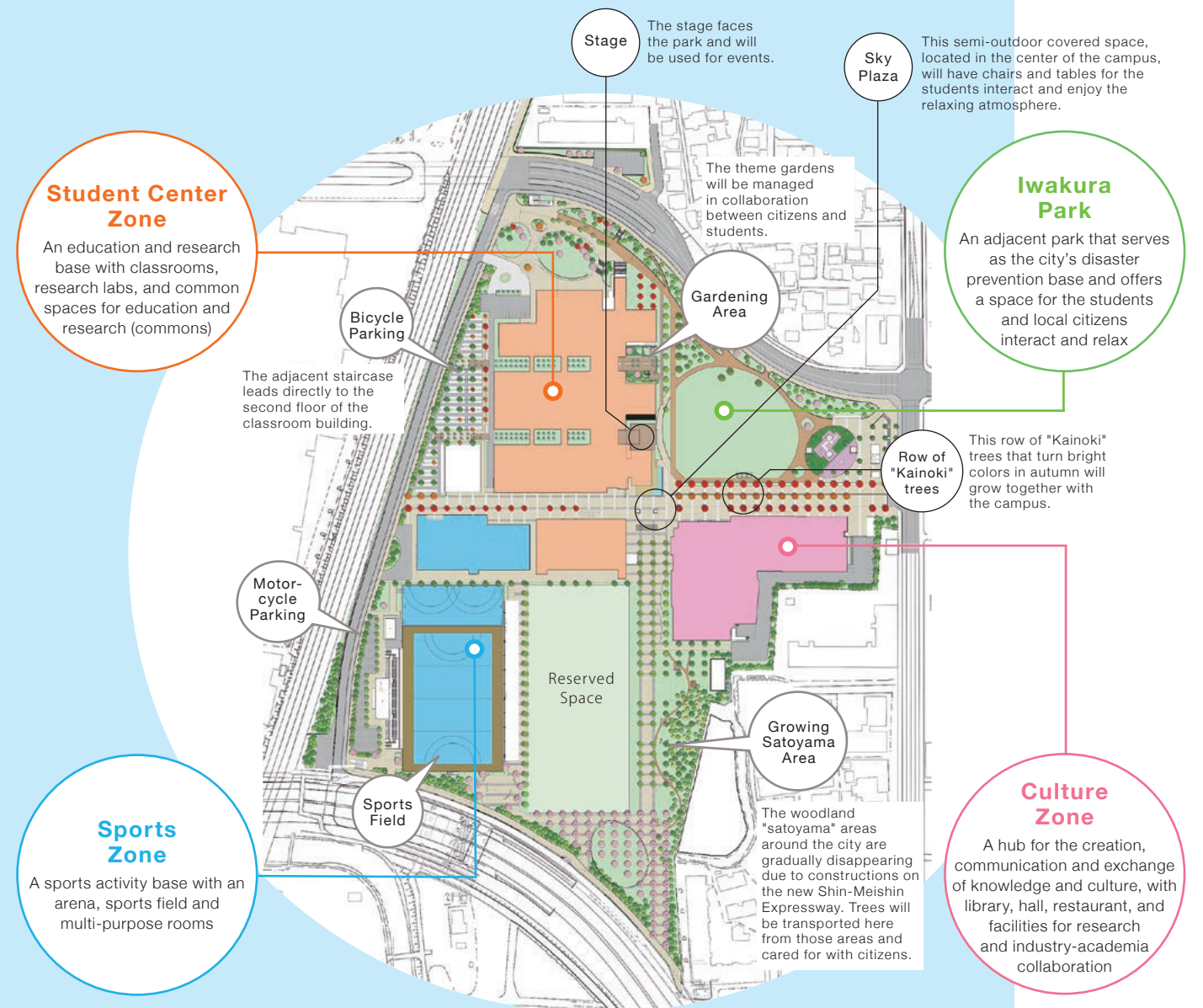

View from JR Kyoto Line



Overall view of campus and Iwakura Park

\* Perspective image according to concept as of March 2014. Iwakura Park designs were produced by the university based on current Ibaraki City plans and are subject to change.  
\* All facility names are tentative.



## Introducing the Facilities

### Classrooms

Classrooms will accommodate not only the traditional school style, but also a variety of active learning styles including group work, discussions, and workshops. Some of the class rooms will be equipped with movable chairs and desks, whiteboards, and audiovisual systems, adaptable to the learning style of each user.



### Common Spaces (Commons) and Information Environment

Common spaces (commons) will be located in different places around the campus, including the Academic Support Commons, the library's Learning Commons, the ICT-specialized Media Lab, the Academic Lounge for undergraduate education, and the Idea Lab with a focus on developing entrepreneurs. There will also be wireless LAN connection throughout the campus, and free loans of laptop computers.

### Library

The library is a comprehensive library for both study and research. Portions of the reading space face the adjacent Iwakura Park, creating an open space perfect for studying. The Learning Commons and the rooftop Garden Library will also provide special spaces. As with the other libraries, students will be able to order library archives from other campuses.

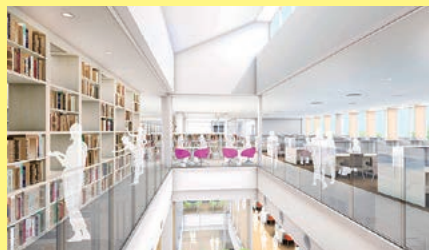

### Concourse

The great concourse, max 18m wide and 200m long, will run north to south across the classroom building, and serve not only as a pathway between classrooms but also as an open space for a variety of activities such as studying, networking, public announcements and taking breaks.

The entire campus will be a place of learning with a variety of spaces and functions where students can study at any time, at any place, and with anyone. OIC will be considered a "communication hub for student culture," open to the community and ultimately to the world, where student activities will be announced within and outside of the university.

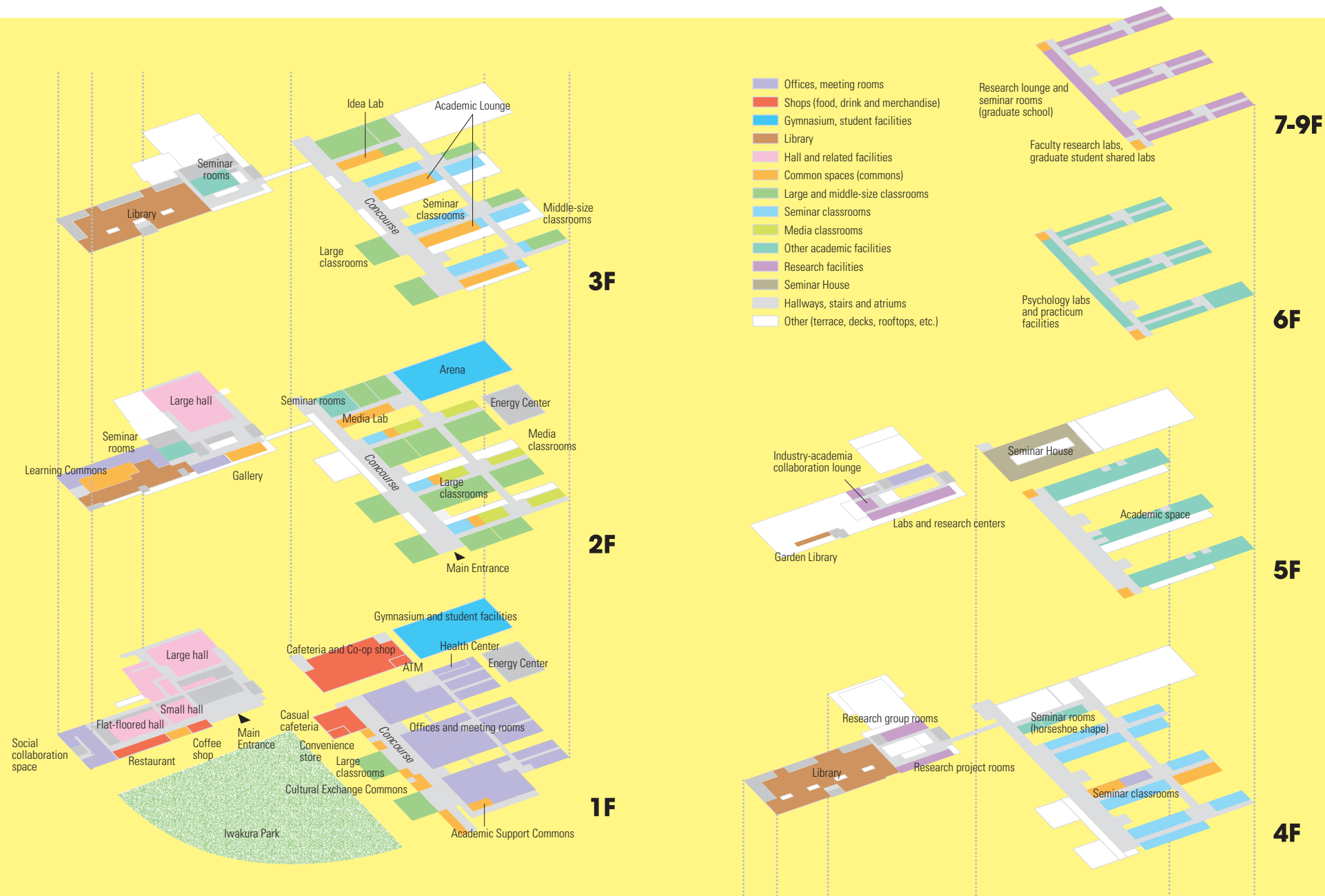

### Shops

A variety of food and drink shops and merchandise shops will serve the needs of the many different members of the campus. There will also be spaces where students can come together and socialize, such as the semi-outdoor Sky Plaza and the adjacent Iwakura Park.

### Cafeteria (Ritsumeikan Co-op)

The food court will provide meals that keep students healthy. Open from morning to night, there will be a variety of meals and menus, which will accommodate the diverse food customs of international students as well.



### Coffee Shop (STARBUCKS)

The coffee shop will offer pastries, sandwiches, and a wide range of espresso drinks using high-quality Arabica coffee beans.



### Casual Cafeteria (Camping Kitchen)

This place provides a casual atmosphere as if you are camping, and will also be available for parties and official dinners. Lunch will be served in a buffet style, with main dishes, salads, breads and more, and during dinner time the establishment will be a restaurant and bar.



### Restaurant

The restaurant will be open to students as well as citizens and visitors, and will also be available for parties and official dinners. Lunch will be served in a buffet style, with main dishes, salads, breads and more, and during dinner time the establishment will be a restaurant and bar.



### Convenience Store (Seven-Eleven)

The convenience store will offer rice balls, breads, lunch boxes, drinks, snacks and special Seven Café fare. Complete with a multi-use copier with administrative services, Seven Bank ATM, payment agency services and delivery service.

### Ritsumeikan Co-op Shop

This shop will provide textbooks, books, magazines, stationery, computers, and more, will accept certification exam applications, and offer travel agency services, room finding services and other services that support campus life.

### Arena and Student Facilities

The first floor will include training rooms, changing rooms, soundproof practice rooms, multi-purpose rooms, and club lockers with lounges. The second floor will include an arena that can fit three basketball courts.



### Outdoor Field

This artificial-lawn field and spectator stand is intended for classes, public use, and a practice space for the Hockey Club which will be moving to OIC.

### Halls

#### Large Hall (capacity 1,000)

This will be Ritsumeikan University's largest hall, equipped with a sound system for concerts and lectures, a stage that accommodates a full orchestra, and booths for simultaneous interpretation.



#### Small Hall (capacity 135)

This hall with fixed chairs and desks will be used for academic society meetings, lectures and more.



#### Flat-floored Hall (seating capacity 400)

This facility with movable chairs and desks will be used for events and receptions, and can be divided with partitions.

### Seminar House

The Seminar House, containing overnight accommodations, will be located on the fifth floor of the classroom building. With a capacity of approximately 120, students and faculty will be able to use it for classes, student activities, international exchange, and more.

# 3 Moving to Ibaraki? Or Commuting from Your Current Residence?

## Moving VS. Commuting

Please use the charts on this page as reference to decide whether to move closer to OIC or commute from where you live now, according to commuting time, fees and your lifestyle (extracurricular activities, part-time jobs, certificate qualifications, etc.).

### Commuting Fees (1 month)

#### Commuting from current residence

**BKC student** Example: Lives close to BKC, wants to ride bicycle to Minami-Kusatsu Station

1-month bicycle parking around Minami-Kusatsu Sta. [Reference] Minami-Kusatsu Station Bicycle Parking (outdoor)	¥1,800
Student commuter pass between JR Minami-Kusatsu Sta. and JR Ibaraki Sta.	¥11,390
Total	¥13,190

**Kinugasa student** Example: Lives near Enmachi, wants to use Hankyu for the cheaper commuter fees

1-month bicycle parking around Saiin Sta. [Reference] Hankyu Saiin Bicycle Parking Center	¥2,300
Student commuter pass between Hankyu Saiin Sta. and Hankyu Minami-Ibaraki Sta.	¥4,290
Total	¥6,590

**Kinugasa student** Example: Lives near Enmachi, wants to use JR which is closer to home

Student commuter pass between JR Enmachi Sta. and JR Ibaraki Sta.	¥8,780
Total	¥8,780

#### Moving near OIC

**Bicycle or walking**

Bicycle, walking	¥0
------------------	----

### Commuting Time (estimate)

#### Commuting from current residence

**BKC student** Example: Lives close to BKC, wants to ride bicycle to Minami-Kusatsu station

Home – JR Minami-Kusatsu Sta. (bicycle)	Approx. 15 min	<b>Leaving home in time to make a 9:00AM class</b> JR ↓ 7:55AM depart Minami-Kusatsu Sta. 8:38AM arrive Ibaraki Sta.
JR Minami-Kusatsu Sta. – JR Ibaraki Sta. (train)	Approx. 40 min	
JR Ibaraki Sta. – Campus (on foot)	Approx. 5 min	
Total	Approx. 60 min	

\*Timetable based on that as of March 2014 and is subject to change. Please use it as reference only.

**Kinugasa student** Example: Lives around Enmachi, wants to use Hankyu for the cheaper commuter fees

Home – Hankyu Saiin Sta. (bicycle)	Approx. 15 min	<b>Leaving home in time to make a 9:00AM class</b> Hankyu ↓ 8:00AM depart Saiin Sta. 8:28AM arrive Minami-Ibaraki Sta.
Hankyu Saiin Sta. – Hankyu Minami-Ibaraki Sta. (train)	Approx. 30 min	
Hankyu Minami-Ibaraki Sta. – Campus (on foot)	Approx. 10 min	
Total	Approx. 55 min	

\*Timetable based on that as of March 2014 and is subject to change. Please use it as reference only.

**Kinugasa student** Example: Lives around Enmachi, wants to use JR which is closer to home

Home – JR Enmachi Sta. (on foot)	Approx. 5 min	<b>Leaving home in time to make a 9:00AM class</b> JR ↓ 8:01AM depart Enmachi Sta. 8:38AM arrive Ibaraki Sta.
JR Enmachi Sta. – JR Ibaraki Sta. (train)	Approx. 40 min	
JR Ibaraki Sta. – Campus (on foot)	Approx. 5 min	
Total	Approx. 50 min	

\*Timetable based on that as of March 2014 and is subject to change. Please use it as reference only.

### Moving fees (estimate)

#### Commuting from current residence

No moving fees ¥0

#### Moving near OIC

Moving fees	¥50,000
Key money	¥150,000
Deposit	¥47,000
Total	¥247,000

\*The above is an estimate based on market price. Please use it as reference only.

### Part-time Job

#### Commuting from current residence

- If you have a part-time job near your current residence, you may have to make changes to your shifts according to your commuting times.

#### Moving near OIC

- You may need to quit your current part-time job.
- Considering the convenient access from Ibaraki to Osaka City, you will have many options when looking for a new part-time job. There are many types of part-time jobs in central Osaka, and the average hourly pay is relatively higher compared to Kyoto and Shiga.

### Job Searching

Large-scale joint company information sessions and major-company screening interviews are often held in Osaka. Therefore, these estimates assume you will travel to Osaka for these functions.

#### Commuting from current residence

JR Minami-Kusatsu Sta. – JR Osaka Sta. Round-trip ¥2,280 x 30 trips <sup>1</sup> (One-way approx. 50 min)	¥68,400
1-month commuter pass for above <sup>2</sup>	¥29,640
JR Enmachi Sta. – JR Osaka Sta. Round-trip ¥1,680 x 30 trips <sup>1</sup> (One-way approx. 45 min)	¥50,400
1-month commuter pass for above <sup>2</sup>	¥23,510

#### Moving near OIC

JR Ibaraki Sta. – JR Osaka Sta. Round-trip ¥440 x 30 trips <sup>1</sup> (One-way approx. 15 min)	¥13,200
1-month commuter pass for above <sup>2</sup>	¥6,480
Hankyu Ibaraki-shi Sta. – Hankyu Umeda Sta. Round-trip ¥540 x 30 trips <sup>1</sup> (One-way approx. 20 min)	¥16,200
1-month commuter pass for above <sup>2</sup>	¥10,010

- \* Fees listed above are based on those as of April 2014 and are subject to change.
- \* 1 The number of round-trips (30) is the average number of trips made while job seeking according to a 2012 Career Center survey on students.
- \* 2 Depending on the number of round-trips you make while job seeking, a commuter pass may be cheaper. You cannot purchase a student commuter pass for job seeking, so the fees are based on regular commuter passes.

## If Moving to Ibaraki...

### Average Rent around Campus (for reference only)

Many landlords around Osaka and Ibaraki require key money, so we recommend including this in your budget. Fees differ according to each property, so please be sure to check all fees carefully before signing a contract.

	Rent (monthly)	Common-area fee (monthly)	Key money	Deposit	Yearly fees *1
Ibaraki area (Within 20 min by bicycle to OIC, approx. 4km)	¥48,642	¥3,491	¥141,688	¥46,438	¥654,973
[Reference] Kinugasa Campus *2	¥45,634	¥5,345	¥31,430	¥68,867	¥622,689
[Reference] BKC *2	¥45,717	¥5,916	¥0	¥101,712	¥619,595

\*1 Yearly fees are the average calculated from total fees over 4 years (4 years of rent, 4 years of common-area fees, and key money, divided by 4).

\*2 References of Kinugasa and BKC rent are based on an average of Creotech contracts.

### Room Searching Schedule

Ritsumeikan Co-op and Creotech will hold consulting sessions at the university for students searching for accommodation. Specific dates, times and venues will be announced when available. \*Sessions will be offered in Japanese only.

2014	Oct	Room Searching Consulting Sessions for Ritsumeikan students, Distribution of pamphlet on room searching *Japanese only
	Nov	Visiting the area, signing contracts
2015	Feb–Mar	Moving

\*Information on the housing guarantor system at OIC will be announced by the International Center in fall of 2014.

### Advice Counter for Room Searching

Ritsumeikan Co-op/Creotech Kinugasa ☎ 0120-606-315 BKC ☎ 0120-077-390

### Areas with Accommodation for One Person

There are many rooms for single-person households around the campus and near stations along the JR and Hankyu lines, with varying rent, sizes and facilities.

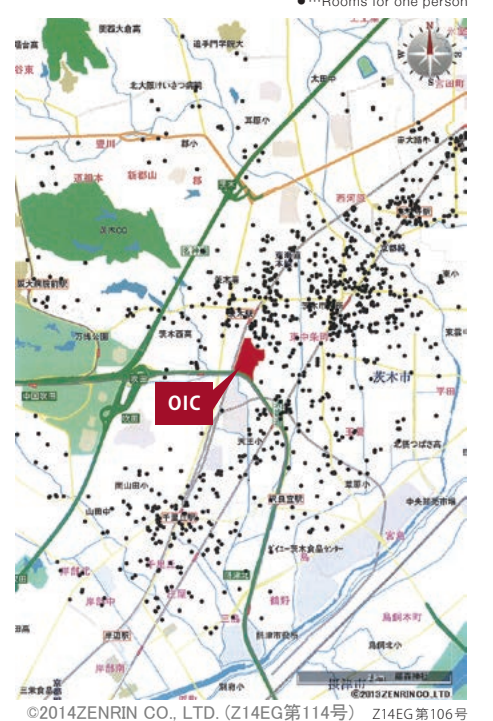



## 4 Bicycle Parking and Rules on Commuting

### About Bicycle Parking



**Bicycles**  
**Motorized Bicycles**  
**Motorcycles under 125cc**

Bicycles, motorized bicycles and under 125cc motorcycles can be parked on campus. Motorcycles are not recommended, and will be allowed only when necessary, provided the student takes a "Motorcycle Safety Class" and registers for "Motorcycle Commuting." Details on registration, etc., will be announced when available.



**Vehicles**  
**Motorcycles over 125cc**

Vehicles and motorcycles over 125cc are not allowed on campus as a general rule.

### Commuting Routes

- The campus is surrounded by residential areas, so we are planning to designate a commuting route. The routes will be announced on our website, etc., once available.
- When riding your bicycle or motorcycle, please adhere to traffic rules and drive safely at all times.

## 5 Maintenance on Roads Around the Campus

Ibaraki City is planning to work on roads and a pathway especially for pedestrians from JR Ibaraki Station to OIC and is gradually preparing the roads for student commuting.

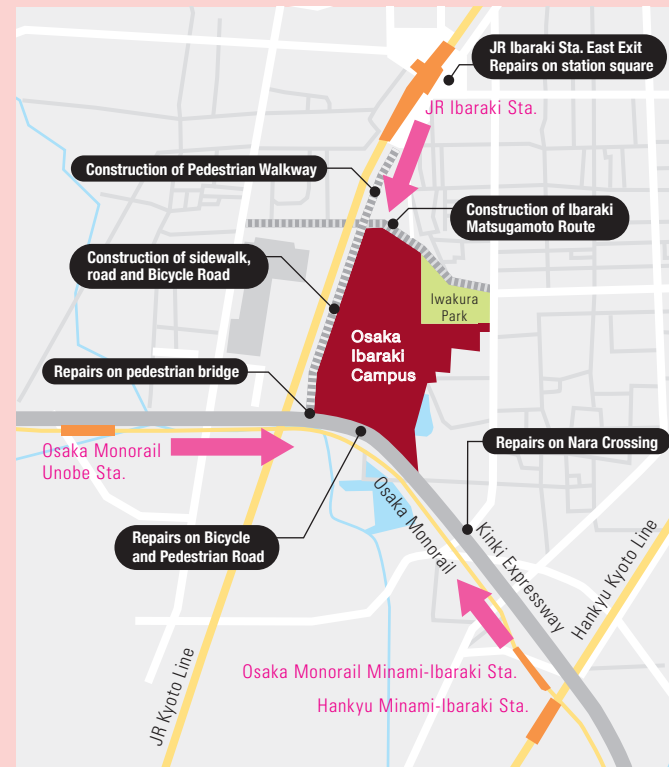
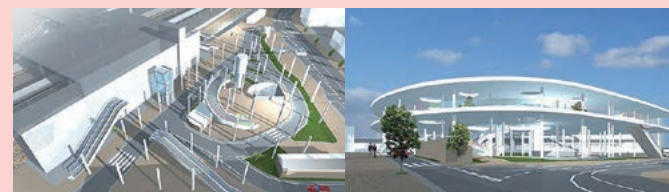

Image of JR Ibaraki Station, East Exit Square



\* Perspective image according to publicly available Ibaraki City plans as of March 2014. The surrounding areas are simplified and differ partially from the actual situation.

## 6 Club Activities

OIC will be considered a "communication hub for student culture," and will support student development and encourage community-based learning through student activities such as scholarship, research and volunteering.

The below clubs will be based at OIC starting April 2015.

- Hockey, Badminton, Volleyball
- Symphonic & Marching Band, Cheerleading

Many other clubs are considering taking part in activities across Ritsumeikan University's three campuses.



Many students have already started activities in Ibaraki.

## 7 Transportation Between Campuses

### Shuttle Bus

We are planning to operate a shuttle bus between OIC, Kinugasa Campus and BKC starting April 2015. Fees and timetables will be based on the current shuttle bus. Details will be announced on the university website, etc., as soon as available.

\* Due to safety reasons, please refrain from traveling between OIC and BKC, and OIC and Kinugasa Campus by motorized bicycle or motorcycle.

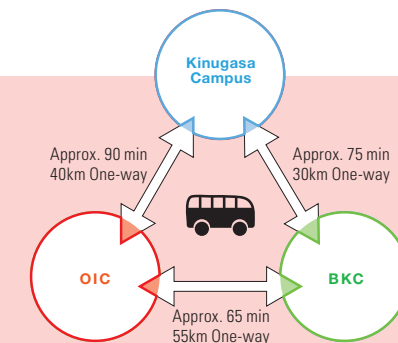

### Public Transportation

Time and fees for public transportation (one-way) are as shown below.

**OIC — Kinugasa Campus** One-way ¥550, approx. 60 min



**OIC — Kinugasa Campus** One-way ¥810, approx. 55 min



**OIC — BKC** One-way ¥1,070, approx. 55 min



\* When using public transportation, a commuter pass may be cheaper depending on how frequently you travel between campuses. You cannot purchase a student commuter pass for extracurricular activities, so the fees are based on regular commuter passes.  
\* Fees are based on those as of April 2014 and are subject to change.

## 8 Regarding Smoking



- Smoking is prohibited on Campus.
- Smoking is also prohibited in Iwakura Park and on roads, due to Ibaraki City's ordinance banning smoking on the streets.

\* "Smoking on the streets" includes smoking or holding a lit cigarette in outdoor public spaces such as streets or parks.



View from the east side

\* Perspective image according to concept as of March 2014.

## 9 Offices to Be Established at OIC

In addition to the administration offices of each college and graduate school, OIC, like other campuses, will have all offices necessary to support the studies and life of undergraduate and graduate students, including supporting offices for extracurricular activities and other student activities, supporting offices for international students and students planning to study abroad, and supporting offices for career development and qualification exams. Many of these offices will be located on the first floor of the classroom building.



**Handbook on Student Activities**  
(Japanese Only)

A handbook on extracurricular activities is scheduled to be published in the fall of 2014, which will detail rules on student activities such as information ads, facility reservations, and free loans of equipment.